OPERATOR'S MANUAL

TIRE  **OMPPARATOR™**



*A Professional “Go/No-Go” Tire
Caliper for Dual-Tire Pairing*





LETTER FROM THE PRESIDENT OF IPA®

My name is Ian Vinci and I would like to thank you for your interest in our products. In today's world, we have all experienced the lack of service and consideration demonstrated by many companies after you buy their products. They say whatever they can to make the sale, and then it's like pulling teeth to get any service response out of them. I know this myself firsthand and because of this, I want to be sure that your experience with IPA® meets your expectations and that IPA® never disappoints you with our service or customer response.

To prove my commitment to you, if for any reason, you are not happy with one of our products, or more importantly, with the response from our customer service department, or any member of the IPA® team, I invite you to contact me directly via my email, president@ipatools.com or call me at 888-786-7899. Your satisfaction is more important to me than the sale itself. We will not be in business for long if we don't make you completely happy with our products and service. I want IPA® to be different and be known for its quality and service.

With that said, please take a look at our product line. You will see innovative first time products that were created to help you do your job faster and better than before. I would also like to invite you to critique our products. If you can think of a better way to make them or changes that will make them work better, please contact me directly and I will be sure to look into it. If you have an innovation and would like some feedback, give me a call.

From all of us at IPA®, we thank you for taking the time to review our product line and wish you and your family the very best of everything.

Ian Vinci
President
IPA®

www.ipatools.com
Toll Free: 888-786-7899
Phone: 845-679-4500
Fax: 845-679-4600

TIRE COMPARATOR PARTS

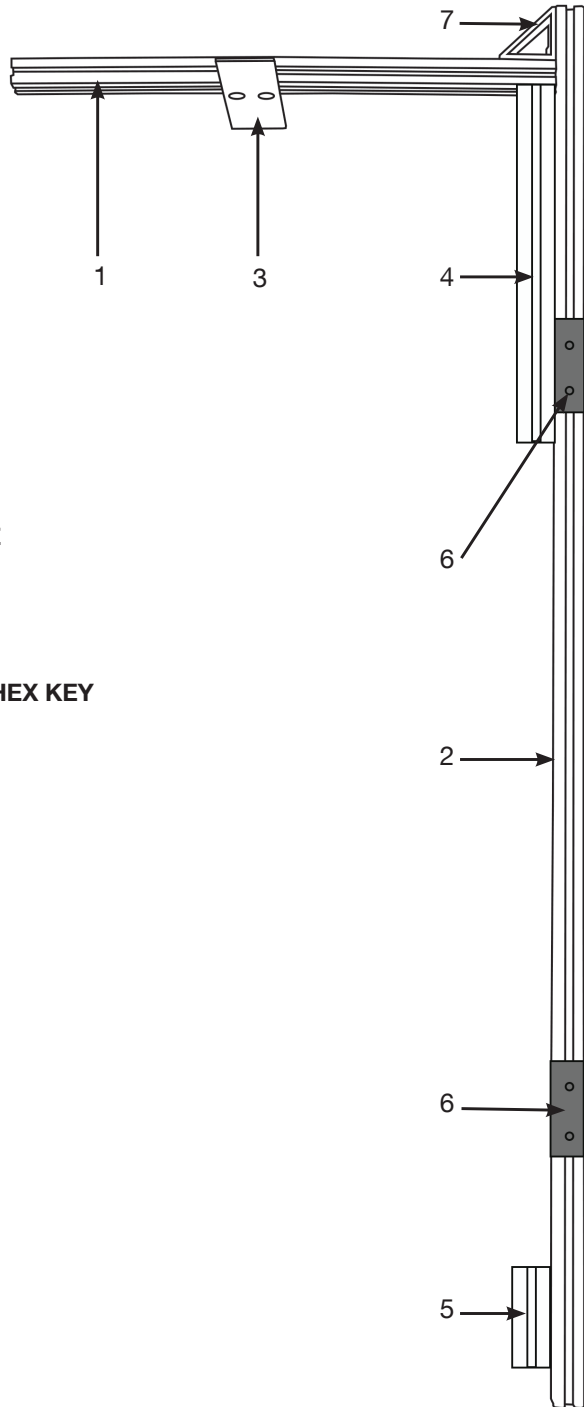

- 1. HORIZONTAL ARM
- 2. VERTICAL BAR
- 3. 1/8" SLIDING GAUGE
- 4. SLIDING SPACER
- 5. FIXED SPACER
- 6. MAGNET PLATES
- 7. LOCK BOLTS AND HEX KEY

ASSEMBLY INSTRUCTIONS

To avoid damage during shipping, the Tire Comparator™ has been partially disassembled. Once reassembled, the Horizontal Arm and Sliding Spacer will move together during height adjustment. All hardware and tools have been supplied with the product for full assembly. Please follow the instructions below. If you have any questions or concerns, call us at 845-679-4500.

A hex key has been supplied for assembling the unit.

1. Locate the blue dots on the 48" Vertical Bar, 20" Horizontal Arm and Sliding Spacer. Once assembled, the blue dots will align with one another (fig. 2).
2. Slide the Horizontal Arm into the groove of the Vertical Bar and slide it down until it hits the top of the Sliding Spacer (fig. 1). Attach the Horizontal Arm to the Sliding Spacer with the provided hex key screw.
3. Set the desired height, then tighten all hex key screws in the Gusset and Sliding Spacer. There should be no rocking or movement within the 90° connection point.

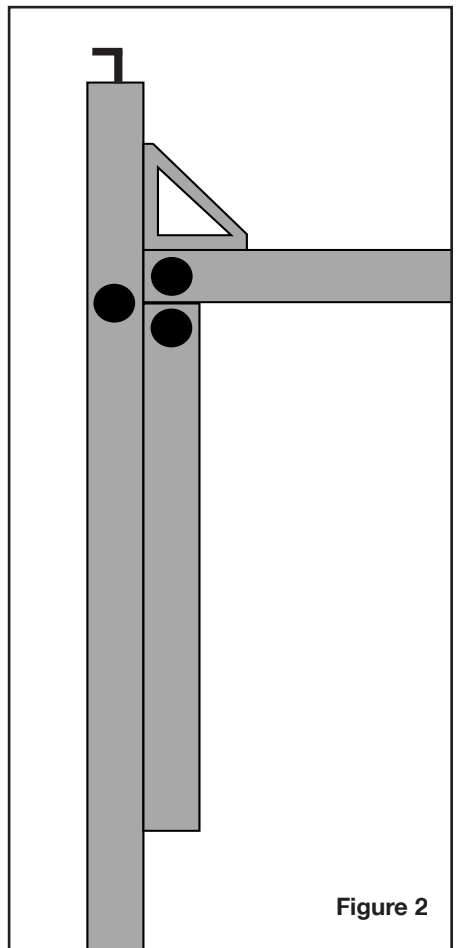
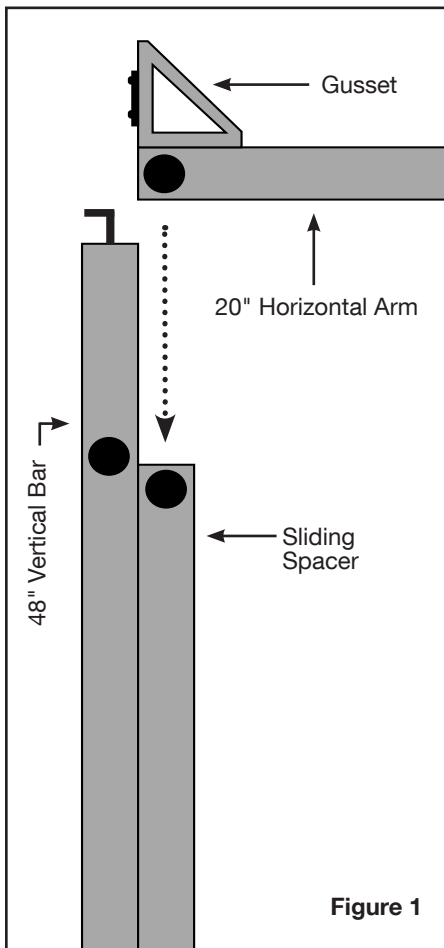

ADJUSTING THE COMPARATOR

The Tire Comparator™ only needs to be adjusted when switching between wheel sizes. The Tire Comparator's Vertical Bar should not touch the ground during testing. When setting the height, be sure the comparator sits at least 1" off the ground, but is long enough to cross the side walls on both sides of the wheel to ensure an accurate reading can be taken.

ADJUSTING THE SLIDE

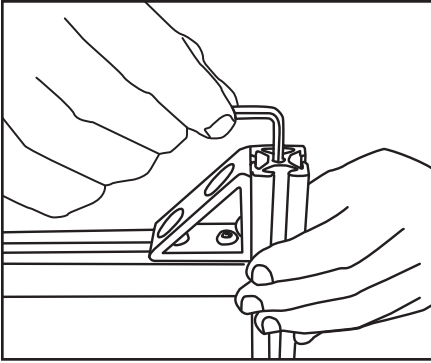

1. Locate the hex key stored at the end of the Vertical Bar.

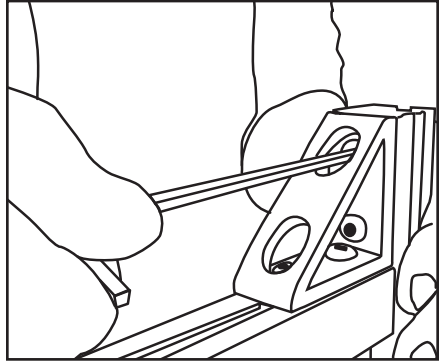

2. Loosen lock bolts on Gusset and Sliding Spacer to adjust height.

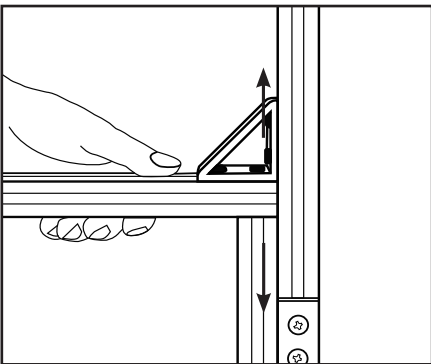

3. Slide Horizontal Arm and Sliding Spacer to desired height.

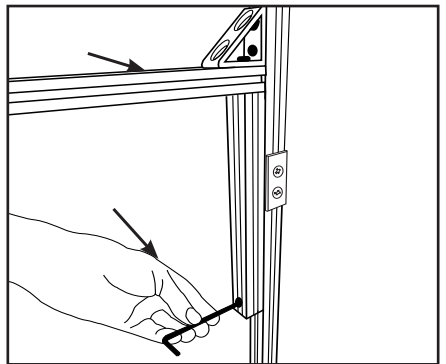

4. Tighten lock bolts on Gusset and Sliding Spacer.

DUAL-MATING CHECK

Use the #9068A Tire Comparator™ Type III to check and compare overall tire diameter of two mated tires. The general accepted tolerance is $\frac{1}{4}$ " overall diameter. If two mated tires are found to be out of tolerance, they must be removed and mated with tires of equal diameter as to avoid premature tire wear and loss of fuel economy.

- 1. PRIOR TO INSPECTION**, make sure both tires are inflated to the same PSI. A difference in PSI could cause a false reading.
- Place the Vertical Bar against the sidewall of the outside tire. The adjustable and fixed spacers should be flush against the lower and upper sidewall. Comparator should not rest on ground.
- Loosen lock bolts with the hex key tool. Slide the Horizontal Arm down until it touches the tread on one of the tires (it may touch both if the tires are equal in height). Tighten the lock bolts until snug (loose bolts can give a false reading).
- Make sure the $\frac{1}{8}$ " Sliding Gauge is placed between the two tires.
- With the tool in position, slide the $\frac{1}{8}$ " Sliding Gauge towards the outside tire.
- Repeat for the inside tire.
- If the $\frac{1}{8}$ " Sliding Gauge hits the sidewall of both tires and doesn't slide over the tread area, the two tires are within tolerance and are considered properly mated.
- If the $\frac{1}{8}$ " Sliding Gauge slides over either the inside or outside tire, the tires do not match and one needs to be replaced with a tire that is within tolerance.

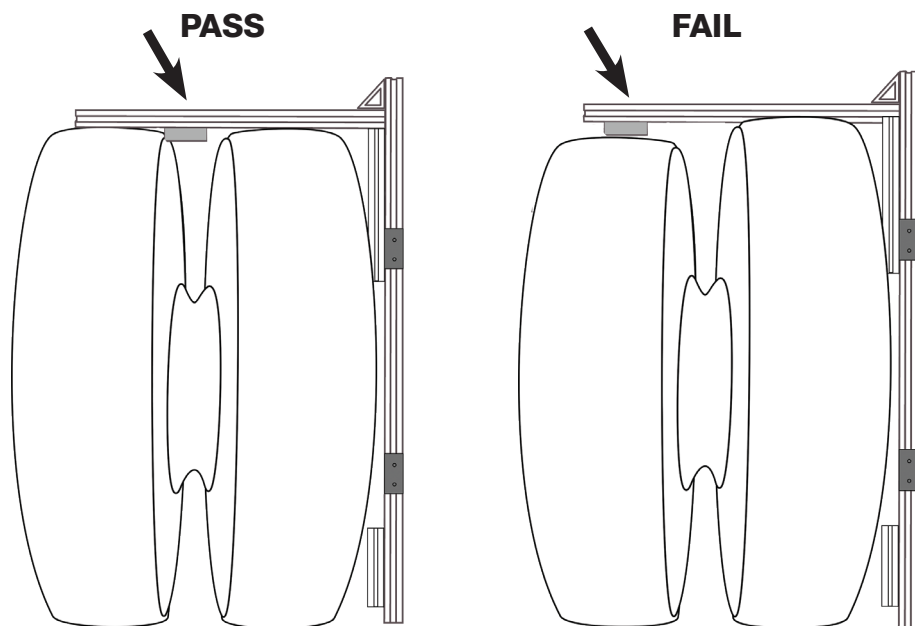

RELATED PRODUCTS

#7884 DISC BRAKE SYSTEM ANALYZER

The Only Tool that Identifies an Imploded Brake Hose and Accurately Detects Exactly Where the Problem Lies Without Breaking a Line.

- Has two load cells attached to analog gauges that each have a range of 0-5000 PSI (0-350 BAR)
- Gauges are built with a red tell-tale memory needle that allows for one-man brake testing
- Tests improperly adjusted proportioning valves, air in hydraulic systems, power booster problems, rear brake adjustment check, etc.
- Tests sticky or broken brake calipers
- Identifies the exact cause of uneven wear



#9107B ELECTRIC BRAKE FORCE METER W/ DYNAMIC LOAD SIMULATION & CIRCUIT TESTING (3RD GEN.)

Test Truck Brake Controllers and Tow Circuits Without a Trailer.

- Simulates trailer brakes so tow vehicles can be tested without a trailer
- Patented technology works with all integrated and aftermarket brake controllers for accurate diagnostics
- Tests all lighting circuits and electric brake systems to detect wiring faults and connection issues
- Includes a 25-ft cord for solo operation and test-drive functionality
- Comes with a soft nylon case for easy storage and transport



Limited One Year Warranty

#9068A TIRE COMPARATOR™ Type III

Innovative Products of America® Incorporated has established a Limited One-Year Warranty Policy for the Tire Comparator™ Series, not including any wearable parts, i.e. lock bolts, etc.

One-Year Limited Warranty/Return or Replace Policy: The product is covered for one year from the date of original user purchase under the stipulations of the Standard Warranty.

The product is warranted to be free from defects in workmanship or material. If there is a problem due to workmanship or material defect, Innovative Products of America® Incorporated will repair or replace the product within 24 working hours after it is received by the IPA® Repair Service Center. In the event it is determined that the product has been tampered with, or altered in any way, the warranty is void and all claims against the product will not be honored. The Warranty Repair/Return procedures require that the proof of purchase must be established (either by warranty card from the seller or by point of purchase receipt/invoice) and the manufacturer makes every attempt to return ship the product within three business days from the receipt of the returned product, freight prepaid.

If it has been determined that the tool has been damaged due to misuse, Innovative Products of America® Incorporated will repair the tool at a cost we deem reasonable and these charges will be the responsibility of the user. We truly want you to be happy with our products, so if you have any questions, call us toll-free at 888-786-7899.



Innovative Products of America® Incorporated
234 Tinker Street, Woodstock, NY 12498
888-786-7899 • 845-679-4500 • www.ipatools.com

© 2026 Innovative Products of America®, Incorporated. All rights reserved. This material may not be reproduced, displayed, modified or distributed without the express prior written permission of the copyright holder. For permission, contact info@ipatools.com.