Operator's Manual

MADE IN

USA



Cleans, Primes and Troubleshoots Diesel Injection Systems
WARNING: Not for Use with Gasoline or Other Highly Volatile Fluids

Innovative Products of America® Incorporated
888-786-7899 • 234 Tinker Street, Woodstock, NY 12498 • www.ipatools.com

© 2018 Innovative Products of America® Incorporated. All rights reserved. This material may not be reproduced, displayed, modified or distributed without the express prior written permission of the copyright holder. For permission, contact info@ipatools.com.



LETTER FROM THE PRESIDENT OF IPA®

My name is Peter Vinci and I would like to thank you for your interest in our products. In today's world, we have all experienced the lack of service and consideration demonstrated by many companies after you buy their products. They say whatever they can to make the sale, and then it's like pulling teeth to get any service response out of them. I know this myself firsthand and because of this, I want to be sure that your experience with IPA® meets your expectations and that IPA® never disappoints you with our service or customer response.

To prove my commitment to you, if for any reason, you are not happy with one of our products, or more importantly, with the response from our customer service department, or any member of the IPA® team, I invite you to contact me directly via my email, president@ipatools.com or call me at 888-786-7899. Your satisfaction is more important to me than the sale itself. We will not be in business for long if we don't make you completely happy with our products and service. I want IPA® to be different and be known for its quality and service.

With that said, please take a look at our product line. You will see innovative first time products that were created to help you do your job faster and better than before. I would also like to invite you to critique our products. If you can think of a better way to make them or changes that will make them work better, please contact me directly and I will be sure to look into it. If you have an innovation and would like some feedback, give me a call.

From all of us at IPA®, we thank you for taking the time to review our product line and wish you and your family the very best of everything.

Peter Vinci
President
IPA®

www.ipatools.com
Toll Free: 888-786-7899
Phone: 845-679-4500
Fax: 845-679-4600

IMPORTANT SAFETY INSTRUCTIONS

IT IS IMPORTANT TO READ, UNDERSTAND AND FOLLOW ALL SAFETY MESSAGES AND INSTRUCTIONS PRINTED IN THIS MANUAL AND ON THE EQUIPMENT BEFORE OPERATING. IF SAFETY INFORMATION IS NOT HEEDED, SERIOUS INJURY OR DEATH TO THE OPERATOR OR BYSTANDERS MAY OCCUR.

DANGER

Indicates a hazardous situation, if not avoided, will result in death or serious injury. The possible hazards are shown in the adjoining symbols or explained in the text.

WARNING

Indicates a hazardous situation, if not avoided, could result in death or serious injury. The possible hazards are shown in the adjoining symbols or explained in the text.

CAUTION

Indicates a hazardous situation, if not avoided, may result in minor or major injury. The possible hazards are shown in the adjoining symbols or explained in the text.

THE FOLLOWING SAFETY ALERT SYMBOLS ARE USED IN THIS MANUAL.



SYMBOL 1: Potential burn hazard. Sparks from electrical shorts can ignite flammable liquids such as fuel or oil. Heat from electrical overloads can cause fire hazards.

SYMBOL 2: Potential explosive air hazard. Pneumatic pressures used with this equipment can cause explosive failures on damaged equipment.

SYMBOL 3: Potential eye hazard. Wear OSHA approved safety glasses. Battery acid and high air pressures create hazardous situations for eyes.

SYMBOL 4: Potential chemical burn hazard. Wear protective gloves. Battery acid is corrosive and can cause skin damage.

SYMBOL 5: Potential fire hazard. Use caution with flammable liquids such as fuel and oil. Electrical shorts can ignite flammable liquids and wiring.

BATTERY GASES, TESTER PREPARATION AND TESTER/CHARGER LOCATION

RISK OF EXPLOSION

- Gases produced by a battery are highly explosive.
- Wear safety goggles and protective clothing, both users and bystanders.
- Use in an area having at least four air changes per hour.
- Read, understand and follow all instructions for charger, battery, vehicle and equipment used near battery and charger.
- Do not smoke, strike a match, place metal tools on battery or cause a spark in the vicinity of the battery. When removing battery cables, remove the ground cable first.
- Clean terminals before charging battery. During cleaning, keep corrosive particles from eyes, nose and mouth. Use baking soda and water to neutralize acid and help eliminate airborne corrosion.
- Never allow clamps on charger cables to touch each other.
- Do not expose tester or charger to rain, snow or wet conditions.
- Do not allow battery gases or acid to contact cabinet. Do not place charger directly above or below battery.



- Fill battery to level specified by battery manufacturer using distilled water.
- Do not remove cell caps while charging per manufacturer's instructions.
- Make sure tester cable clamps make tight connections.
- Battery explosion can cause injury.

GENERAL CHARGER USE

RISK OF ELECTRIC SHOCK AND FIRE

- Before connecting charger to unit, make sure controls are set to OFF.
- Do not remove or bypass the grounding pin.
- Do not operate charger with damaged cord or plug. Replace cord or plug immediately if damage occurs.
- Position power cord and charger cables away from the hood, doors, and hot or moving engine parts where they could be damaged.
- Unplug power cord by grasping and pulling on the plug rather than the cord when disconnecting charger from outlet.
- Charger power cord uses equipment-grounding conductor and a grounding plug. Plug only into a 120V AC outlet that is correctly installed and grounded in accordance with all ordinances and local codes.
- Unplug power cord from outlet before cleaning or maintaining tester and charger. Turning off controls does not reduce the risk of electric shock.
- Do not operate charger after a sharp impact, drop or any other damage.
- Do not disassemble charger.
- Use only recommended attachments.
- Do not charge a frozen battery.
- Do not overcharge a battery.
- Use charger only on lead-acid automotive batteries. Do not use charger for charging dry cell batteries.
- Electric shock or fire can cause injury.



RISK OF ENTANGLEMENT

- Keep yourself, clothing and battery charger leads clear of moving parts such as fan blades, pulleys, hood and doors.
- Moving parts can cause injury.

RISK OF BURNS

- Batteries can produce short circuit current high enough to weld jewelry such as rings, bracelets and watches. You must remove jewelry before working near batteries.
- Short circuits can cause injury.

WHAT'S INCLUDED

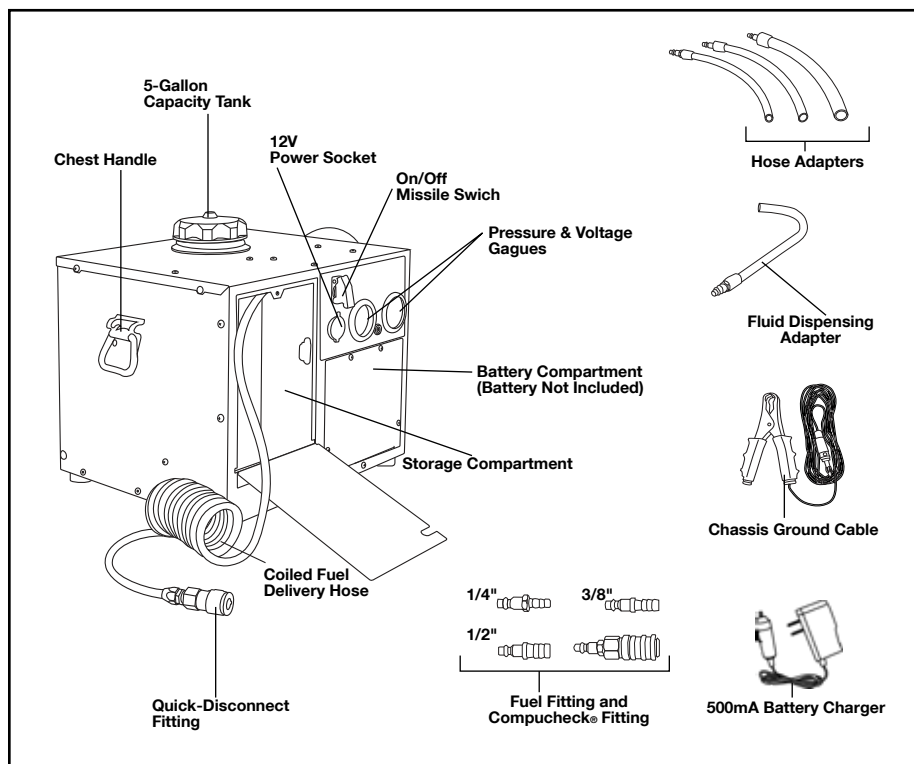

| IPA® Part Number | Description | QTY |
|------------------|---|-----|
| #HS-COIL15-AS | 15' Coiled Air Hose with Quick-Disconnect Fitting | 1 |
| #9081-RDHOSE-AS | 1/2" Red Adapter | 1 |
| #9081-YLWHOSE-AS | 3/8" Yellow Adapter | 1 |
| #9081-BLHOSE-AS | 1/4" Blue Adapter | 1 |
| #9081-BLRIGID-AS | 1/4" Blue Rigid Adapter | 1 |
| #BRB-0002 | 1/2" Barbed Fitting | 1 |
| #BRB-0003 | 3/8" Barbed Fitting | 1 |
| #BRB-0005 | 1/4" Barbed Fitting | 1 |
| #009080-14 | Compucheck® Fitting | 1 |
| #009080-FOOT | Foot | 4 |
| #HDL0008 | Chest Handle | 2 |
| #7900K-2BCHAS | Chassis Ground Cable | 1 |
| #CHR0001 | 500mA Battery Charger | 1 |

Use the Provided Reference Numbers
When Ordering Products and Parts Above
Call Toll Free: 888-786-7899

INTRODUCTION

The Diesel Fuel Injection Cleaner and Primer (#9080) provides a portable, battery-powered, fuel storage and transfer solution for:

- Cleaning diesel injection systems.
- Priming diesel fuel systems after filter and pump changes.
- Isolating the fuel systems from the fuel tank to diagnose a variety of potential issues.
- Filling fuel filters.
- As an alternative (temporary) fuel source.

WARNING: When used for any or more of the functions above, be sure to follow generally accepted safety procedures and follow all local environmental laws and regulations.

WARNING: This system is only intended to be used with diesel fuel, fuel oil and kerosene. DO NOT USE THIS SYSTEM WITH GASOLINE OR OTHER HIGHLY VOLATILE CHEMICALS.

BATTERY REQUIREMENTS/INSTALLATION

CHOOSING A BATTERY

(Manufacturer's Suggested Replacement: Yuasa #YTX14 or Group 14 Equivalent)

- Battery Voltage: 12V DC
- Battery Type: Lead Acid
- Battery Compartment Dimensions: 5 $\frac{7}{8}$ " L x 5 $\frac{3}{4}$ " H x 3 $\frac{3}{8}$ " W

INSTALLING AN INTERNAL BATTERY

1. Remove the four Phillips head screws in the front of the Diesel Fuel Injection Cleaner and Primer.
2. Slide out the battery tray.
3. Place the battery onto the tray with the battery terminals facing the front of the unit. Attach the ring terminal on the red wire to the positive side of the battery and tighten securely.
4. Cover positive terminal with the red boot.
5. Attach the ring terminal of the black wire to the negative battery terminal.
6. Carefully slide the tray into the unit. Use caution – DO NOT ALLOW the positive battery terminal to contact the unit.
7. Reinstall screws to secure.

SET-UP INSTRUCTIONS

1. Place system flat on level surface.
 - Be sure not to tip or turn upside down.
2. Select desired fuel connection adapter for your specific application.
 - Always inspect for loose connections, cut or slit hoses prior to operating this system.
3. Prior to filling up the 5-gallon tank with fuel, turn main power switch to the "ON" position to ensure you have established a proper battery connection. You should hear the internal pump operating.
 - DO NOT OPERATE PUMP longer than a few seconds with out fuel.
4. Unscrew main fuel tank filler cap.
5. Fill internal 5-gallon tank with diesel fuel, fuel oil, or kerosene.
 - Add any fuel conditioners or desired additives during this step.
 - DO NOT fill with gasoline or other highly volatile fluids.
6. Firmly retighten filler cap. **DO NOT OVERTIGHTEN.**

OPERATING INSTRUCTIONS

1. Connect your hose adapter to the fuel system you intend to transfer fuel into.
2. Set main power switch to "ON" position.
3. Note the voltage and pressure gauges.
 - If voltage is low, check battery.
 - Pressure should read between 6-12 psi. If the reading is lower or higher, call tech support at 845-679-4500.

Below are specific usage notes to be used only once you have followed Set-up and Operating Instructions listed above.

PRIMING A FUEL SYSTEM

- Following vehicle or engine manual suggestions, open any bleeder caps/vents to allow air to escape from the system.
- Continue priming system until all air has been removed.

RUNNING ENGINE OR FUEL SYSTEM WITH #9080 INSTALLED AS A PRIMARY FUEL SOURCE

WARNING: Be sure all hoses and adapters DO NOT interfere with fan belts, blades or other moving parts, and DO NOT come in contact with any hot engine components.

- Once air has been removed from the fuel system, you may start the engine or boiler, using the #9080 as the primary fuel source.
- Note that while the engine is running, the fuel return lines will still be sending fuel back to the original fuel tank unless otherwise rerouted. This may drastically effect the overall run time of the #9080's 5-gallon fuel supply.

CLEANING A FUEL INJECTION SYSTEM

- Instead of simply using the #9080 as a fuel source, it is recommended to add fuel additives that will condition the fuel system. Fuel additives may include injection system cleaners, water removers and biocide for killing algae. Add the appropriate amount of additive to the 5-gallon tank based upon the recommended mixture levels provided on the packaging of the fuel additive.
- Operate the engine or boiler while using the #9080 as a fuel source for a few minutes, allowing the additive to clean and service the fuel injection system.

Limited One-Year Warranty

#9080

DIESEL FUEL INJECTION CLEANER AND PRIMER®

Innovative Products of America® Incorporated has established a Limited One-Year Warranty Policy for the Diesel Fuel Injection Cleaner and Primer, not including any wearable parts, e.g. adapters, cables, hoses, etc.

One-Year Limited Warranty/Return or Replace Policy: The product is covered for one year from the date of original user purchase under the stipulations of the Standard Warranty.

The product is warranted to be free from defects in workmanship or material. If there is a problem due to workmanship or material defect, Innovative Products of America® Incorporated will repair or replace the product within 24-working hours after it is received by the IPA® Repair Service Center. In the event it is determined that the product has been tampered with, or altered in any way, the warranty is void and all claims against the product will not be honored. The Warranty Repair/Return procedures require that the proof of purchase must be established (either by warranty card from the seller or by point of purchase receipt/invoice) and the manufacturer makes every attempt to return ship the product within three business days from the receipt of the returned product, freight prepaid.

If it has been determined that the tool has been damaged due to misuse, Innovative Products of America® Incorporated will repair the tool at a cost we deem reasonable and these charges will be the responsibility of the user. We truly want you to be happy with our products, so if you have any questions, call us toll free at 888-786-7899.



Innovative Products of America® Incorporated
234 Tinker Street, Woodstock, NY 12498
888-786-7899 • 845-679-4500 • www.ipatools.com